

# ROBOT ARMY STARTER KIT

## INSTRUCTIONS

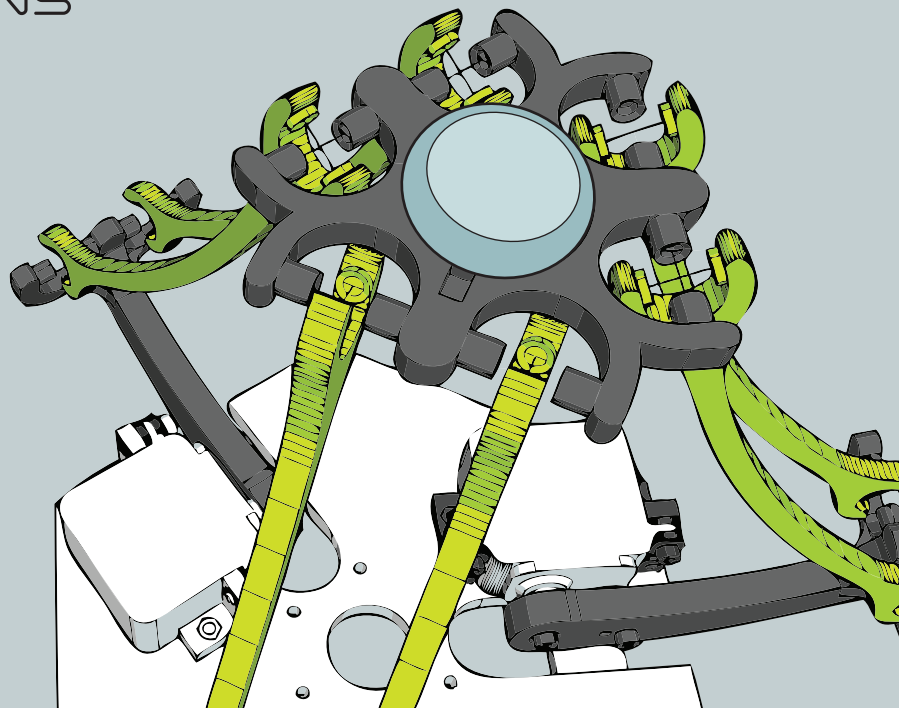

rev C 9.29.14

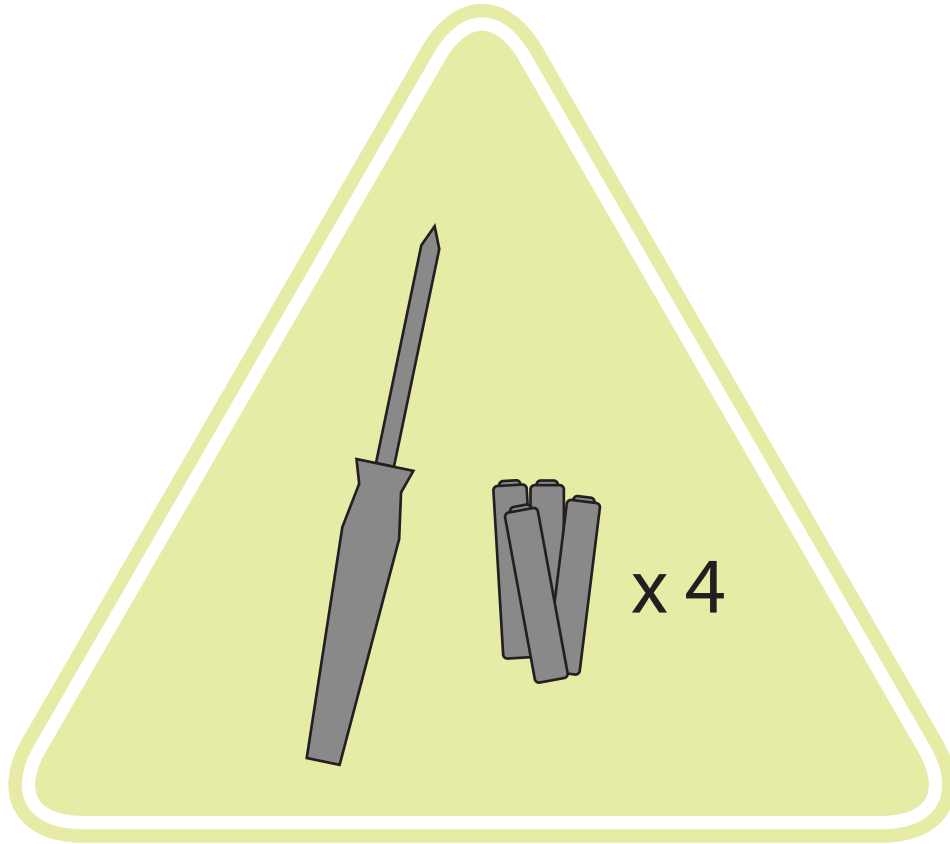

YOU WILL NEED A SCREW DRIVER AND  
( 4 ) AA BATTERIES TO COMPLETE YOUR ROBOT

## NOTICE!

DO NOT skip the calibration step in the instructions. If you do not calibrate your robot's motors before you attach the arms, you risk damaging the motors and the plastic parts.

If you are having trouble understanding a step,  
watch our in depth construction video here :

Coming Soon!



x 12



x 26



x 12



x 2



x 26



x 2



x 3



x 3

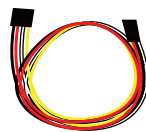

x 1



x 1



x 6



x 3



x 6

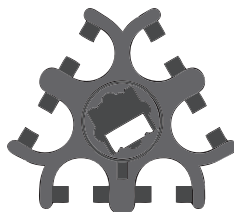

x 1

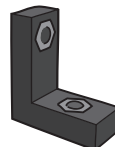

x 6



x 1

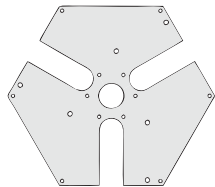

x 1

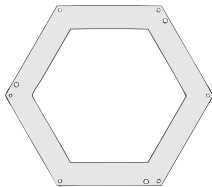

x 1



x 3



x 12

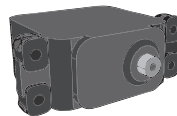

x 3

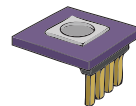

x 1

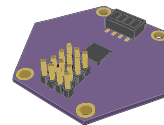

x 1



1

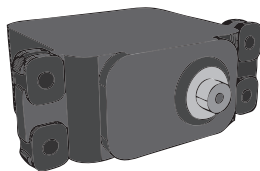

x 4



x 1

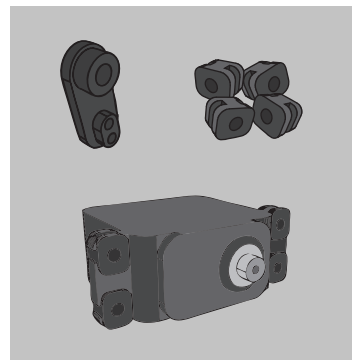

2



x 12

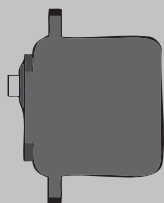

x 3

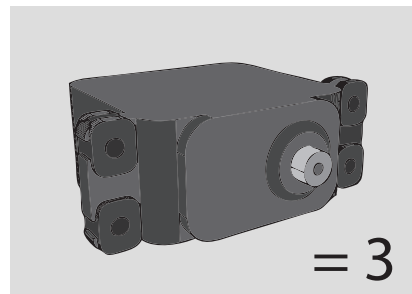
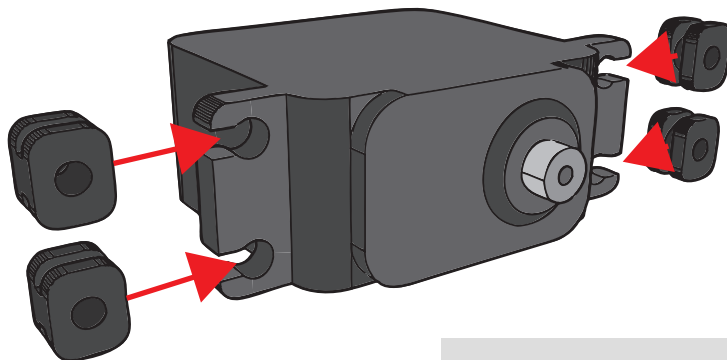
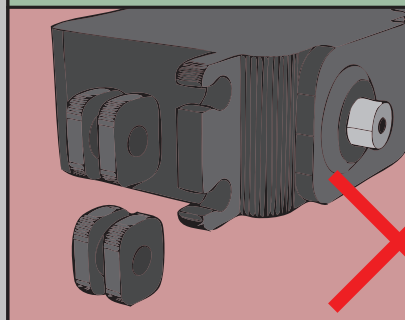
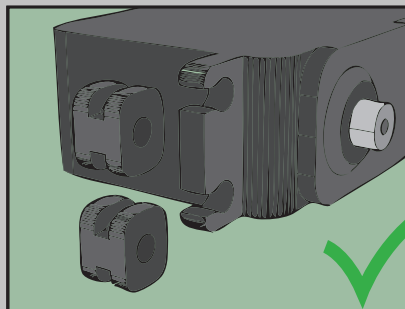
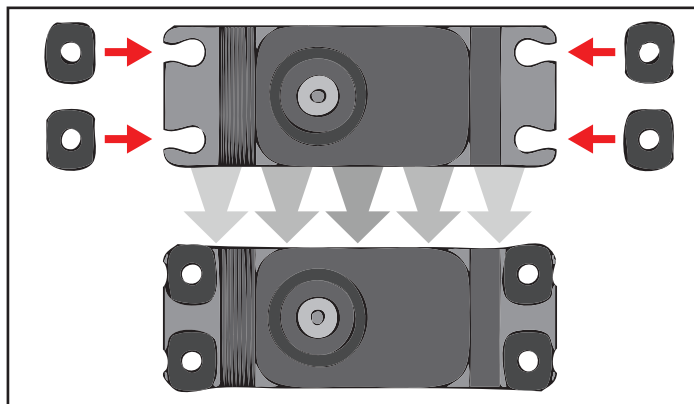

3

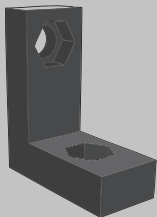

x 6

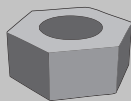

x 12

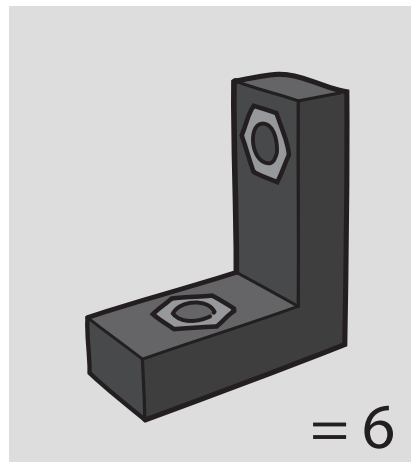
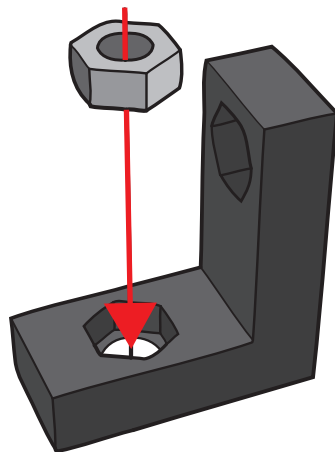
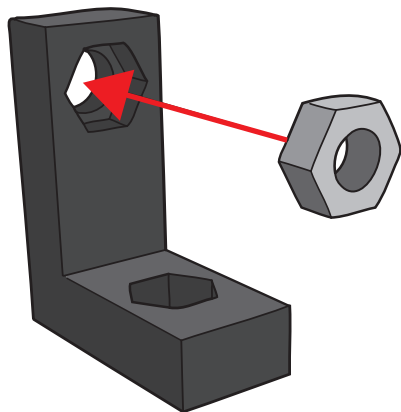
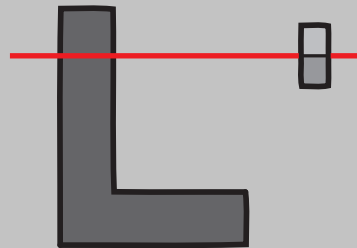
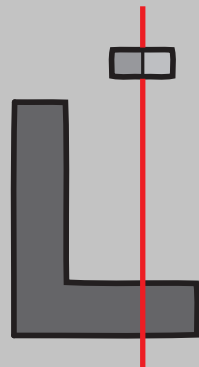

# 4

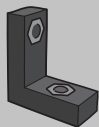

x 6

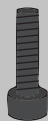

x 6



x 6

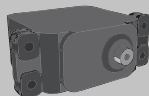

x 3

!

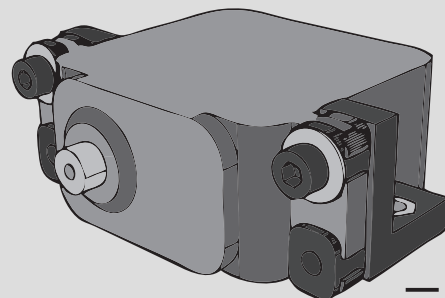
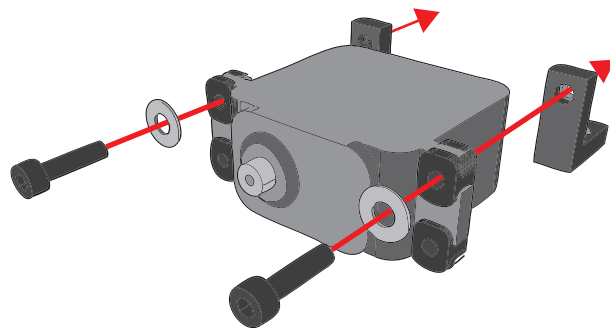
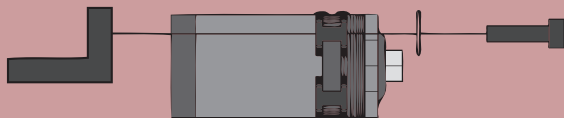
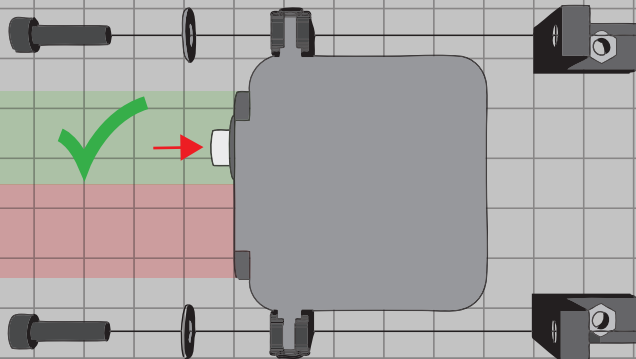

= 3

5

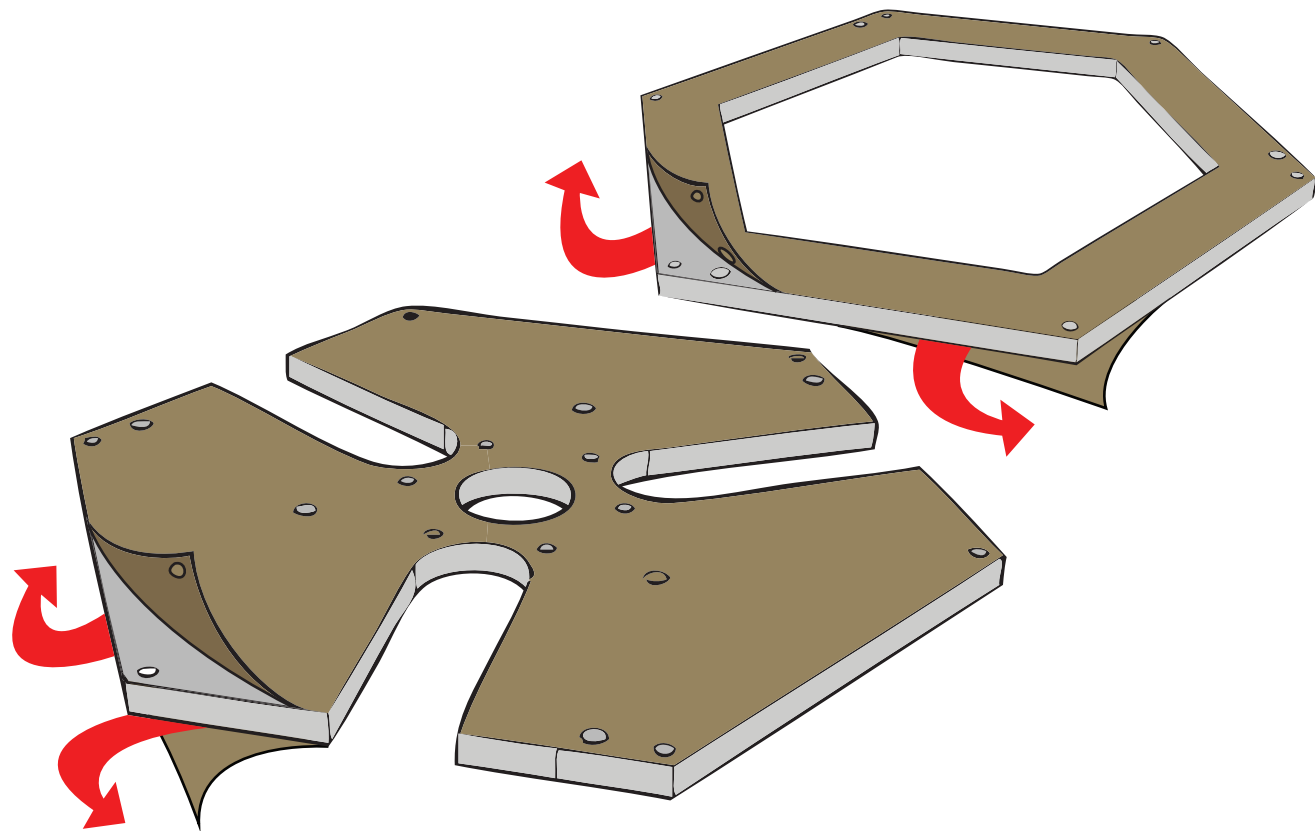

6

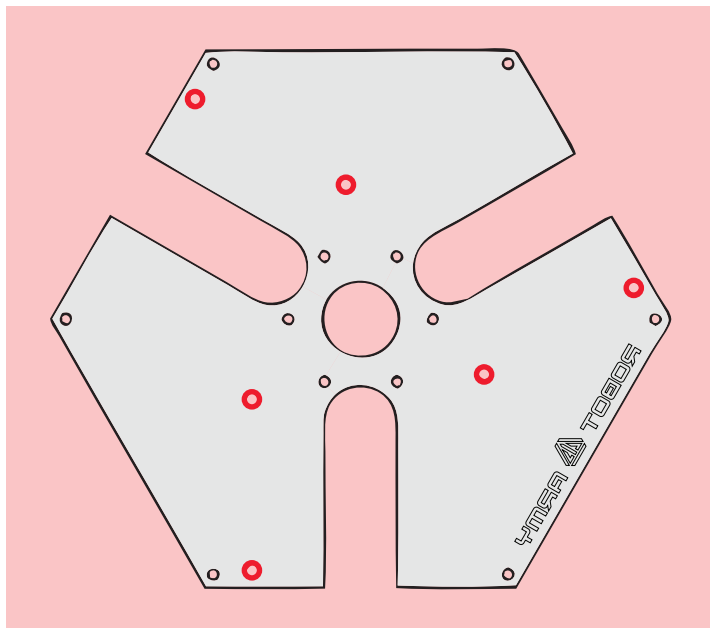
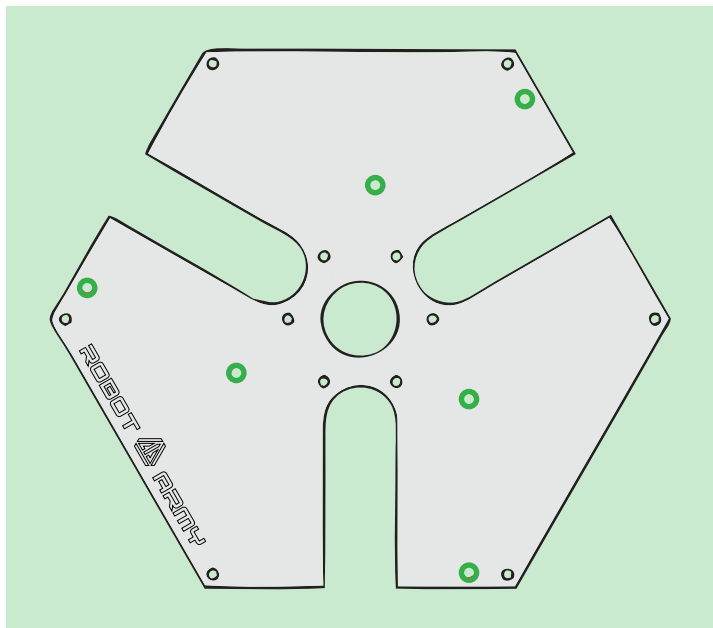

# 7

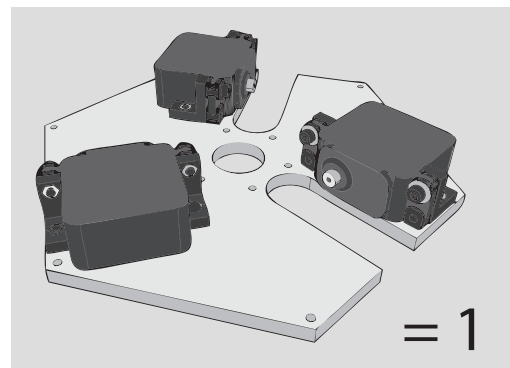
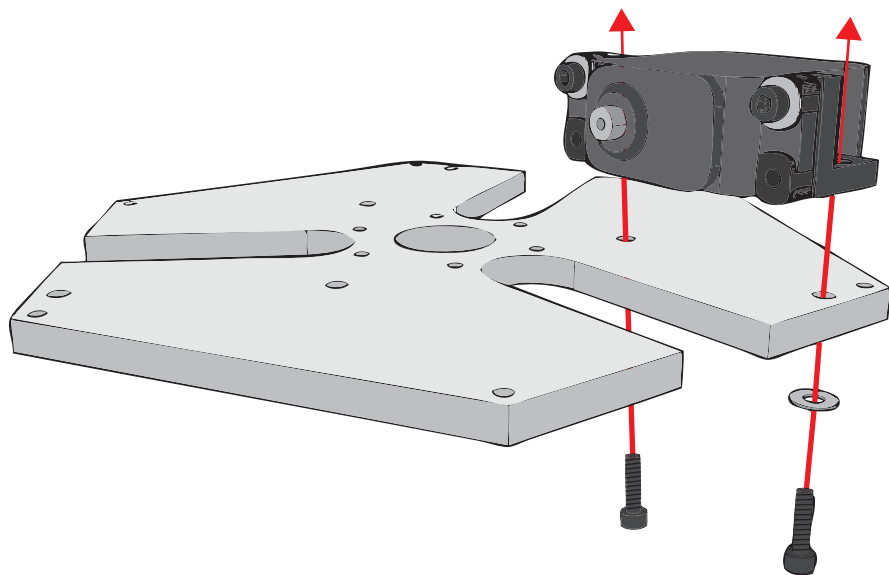
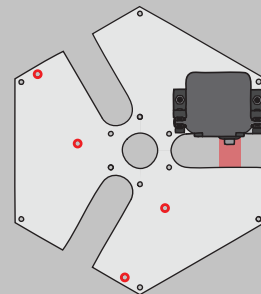
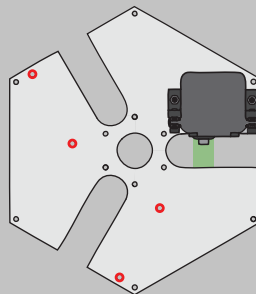
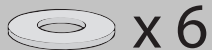
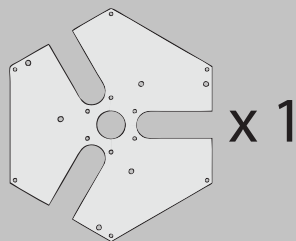
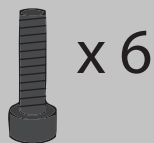
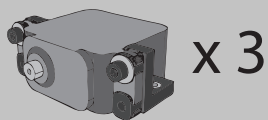

8

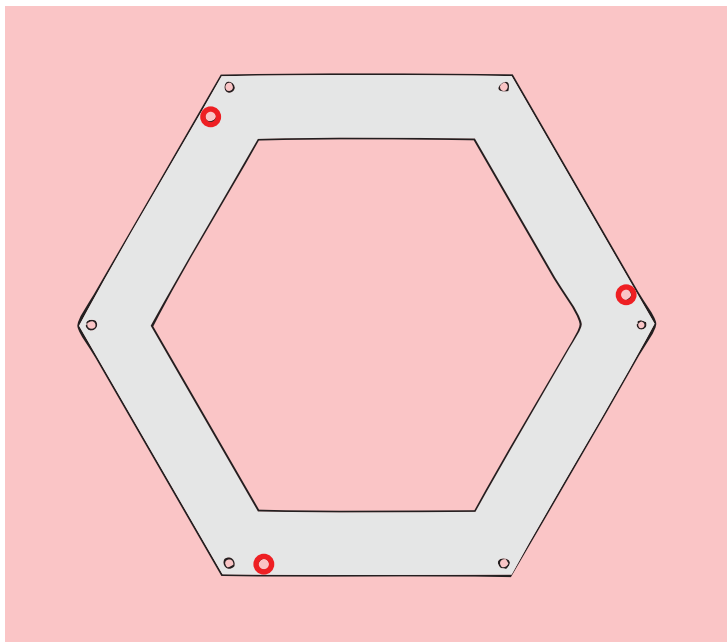
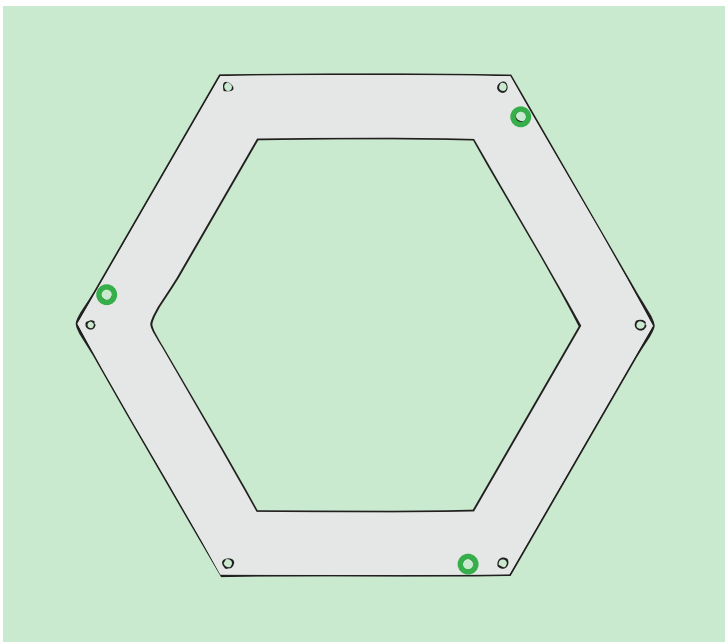



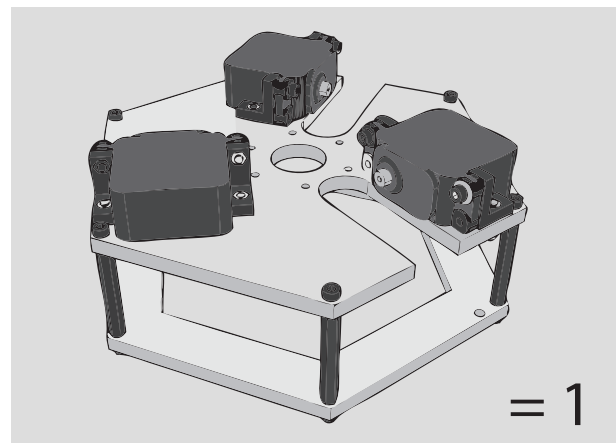
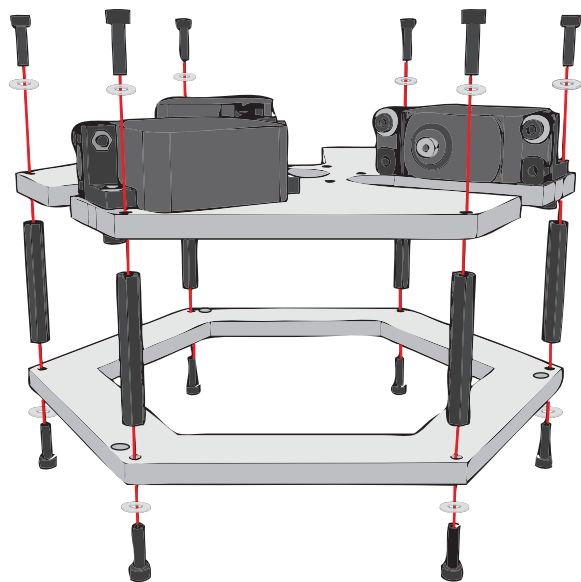
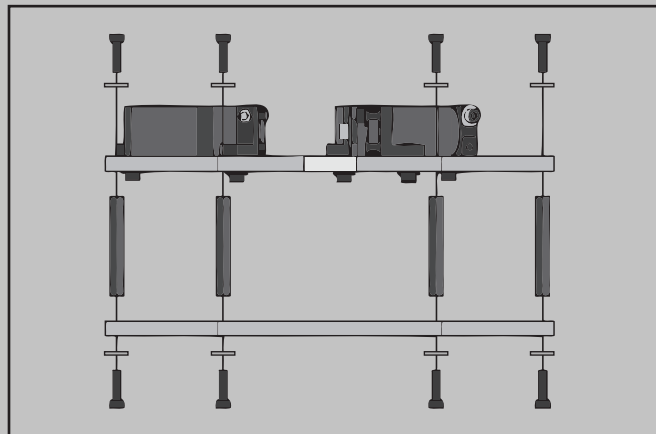
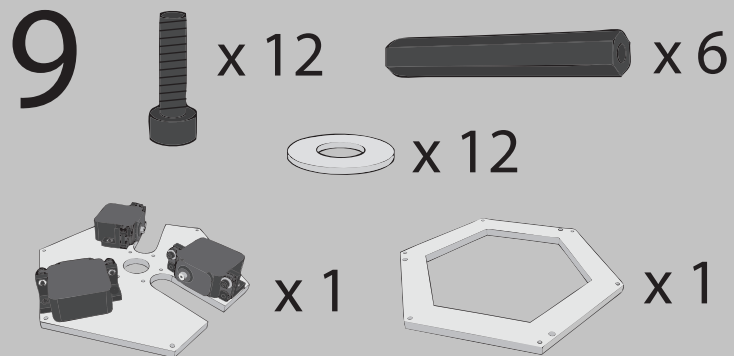

# 10

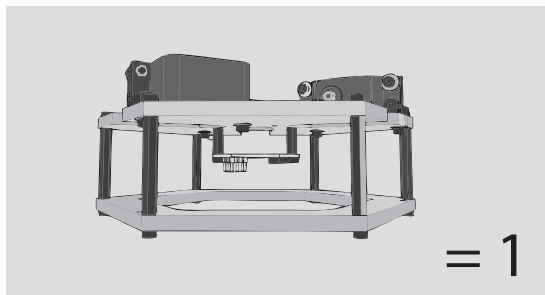
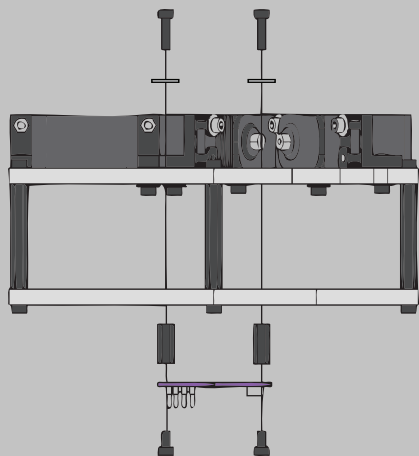
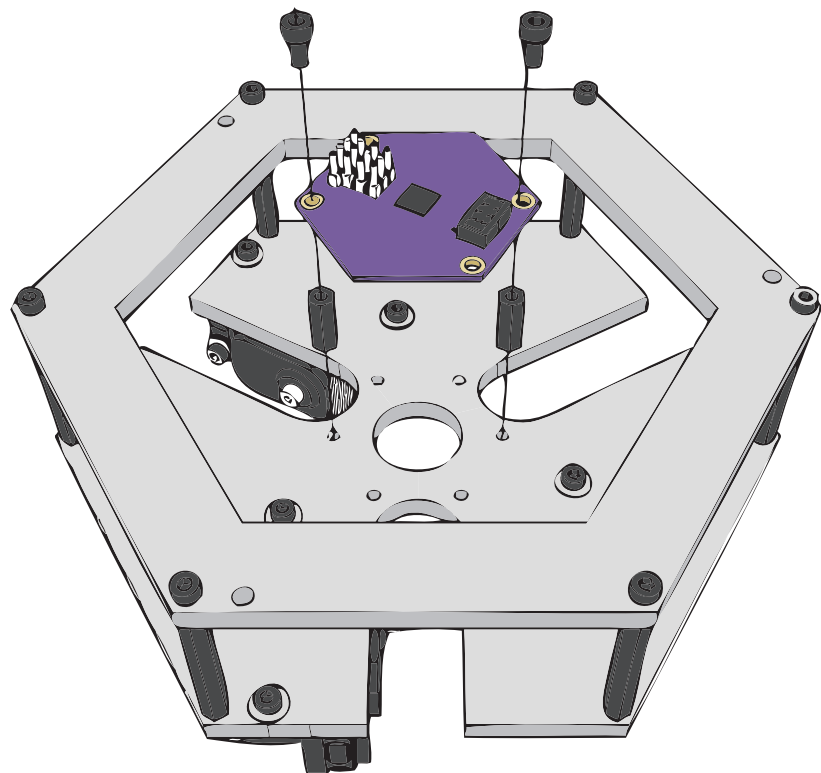
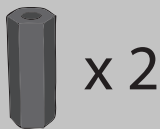
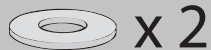
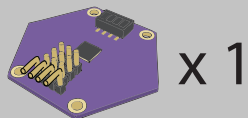
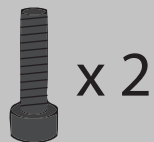
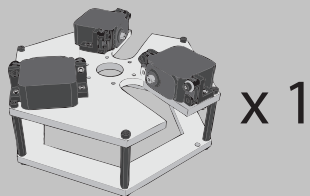

# 11

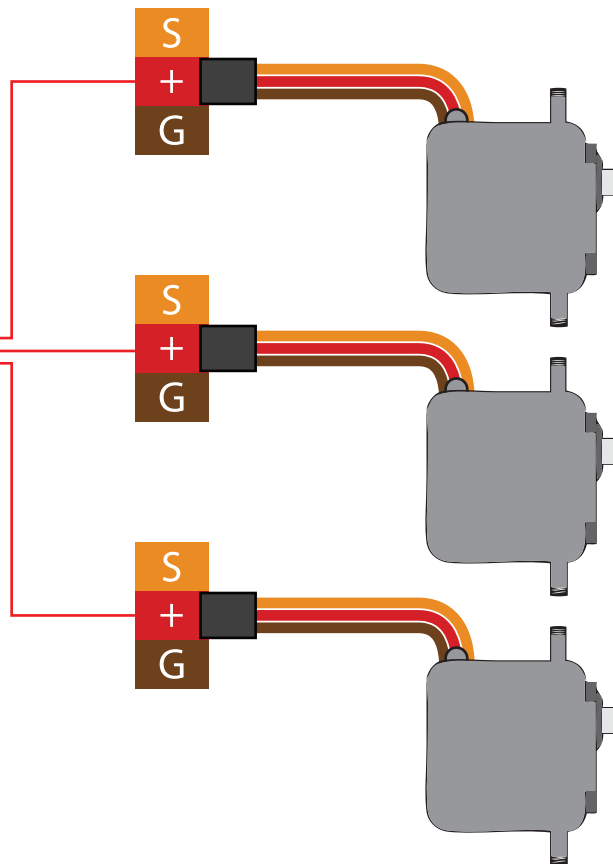
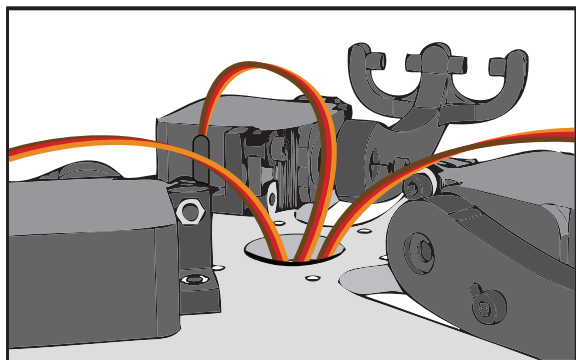
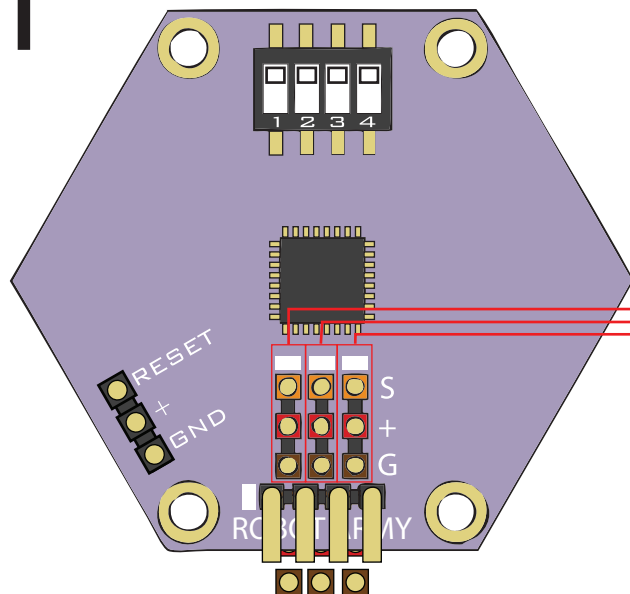

# 12



x 3



x 3

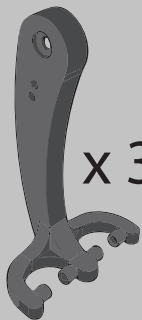

x 3

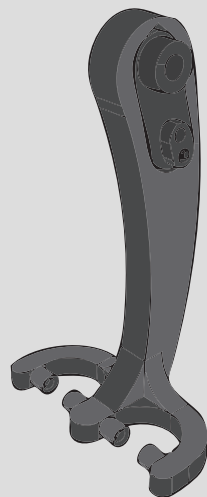
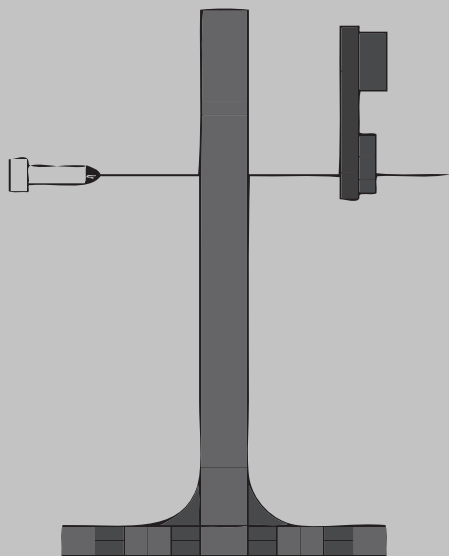
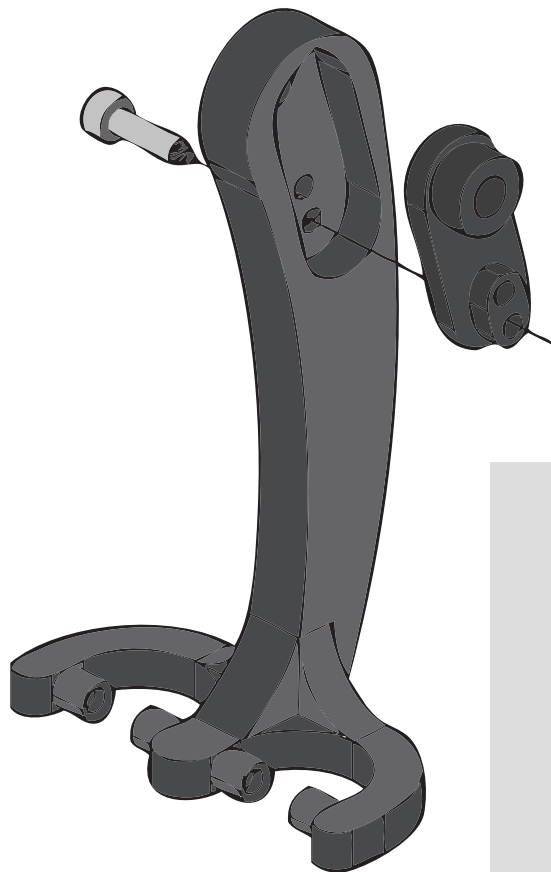

= 3

13

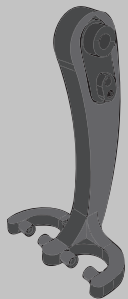

x 3



x 6

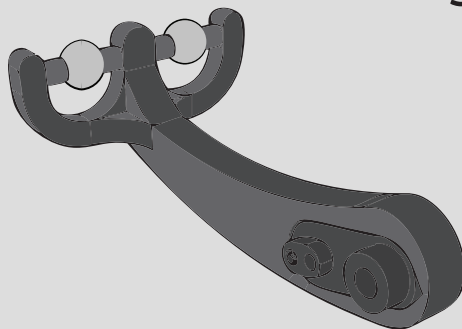
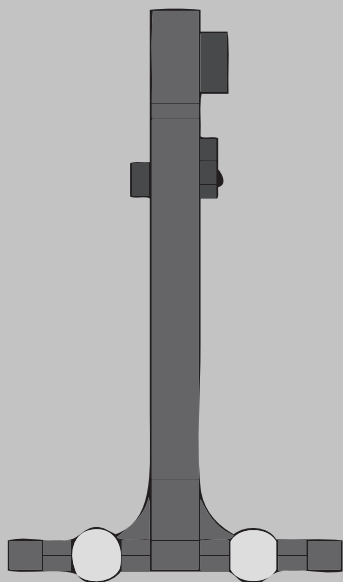
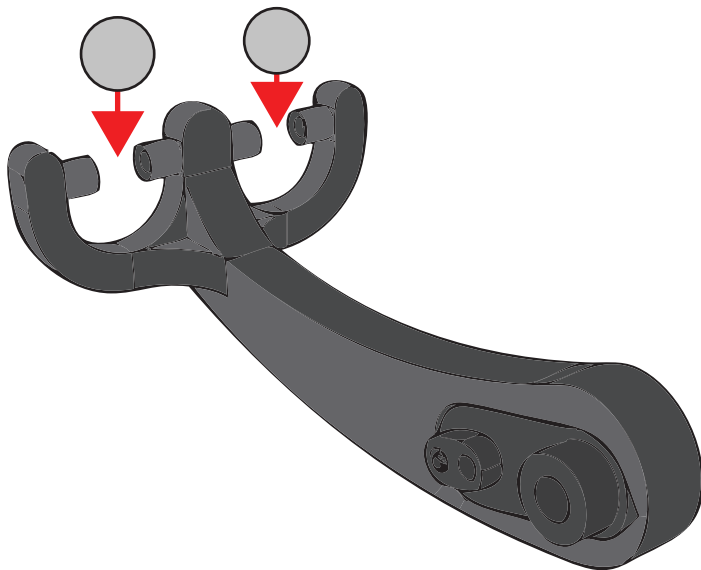

= 3

14



x 4

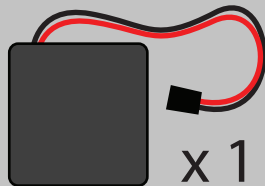

x 1

!

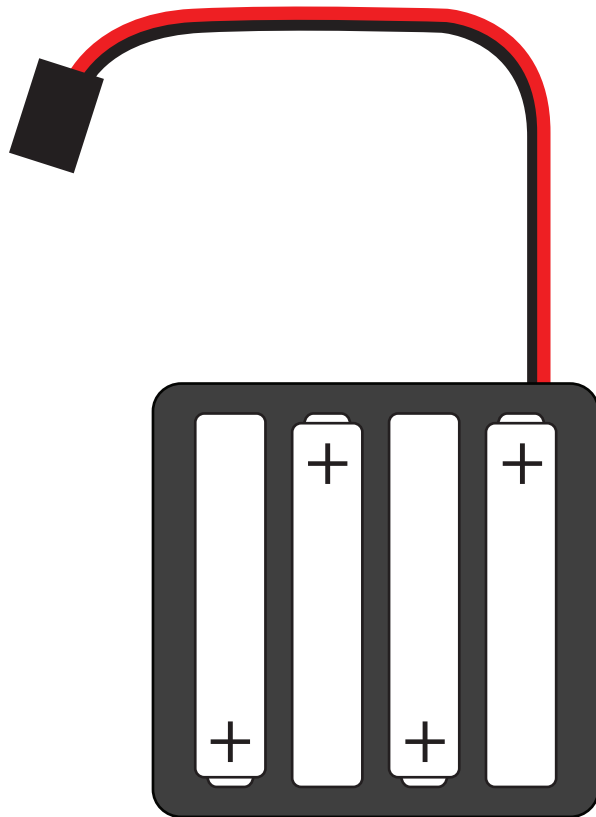
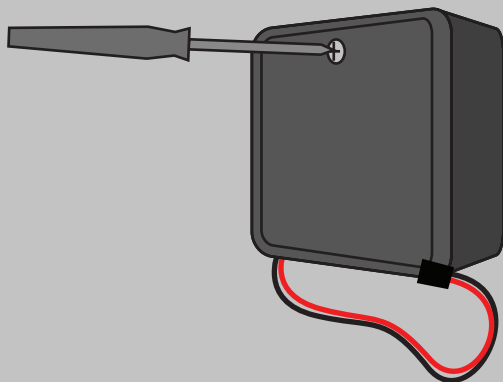

# 15

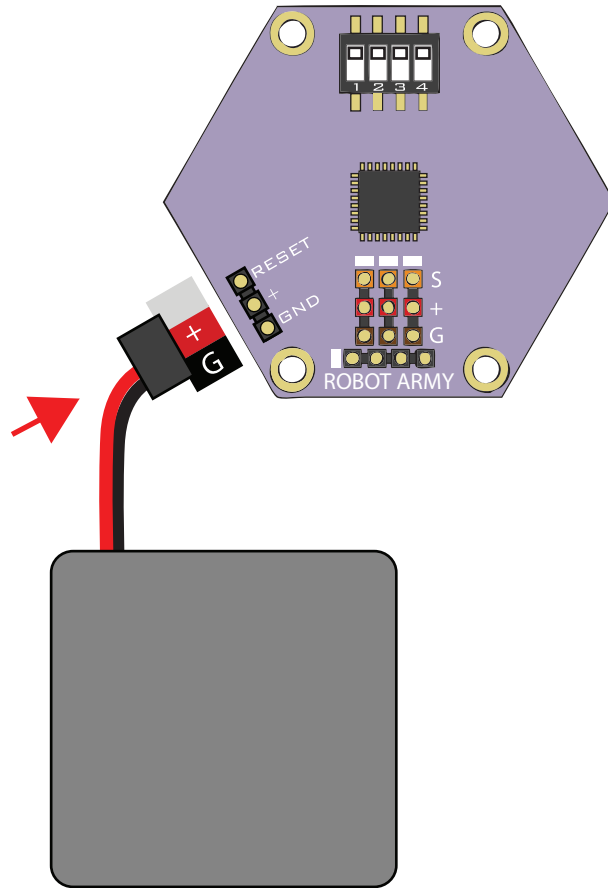

# 16

## CALIBRATION!

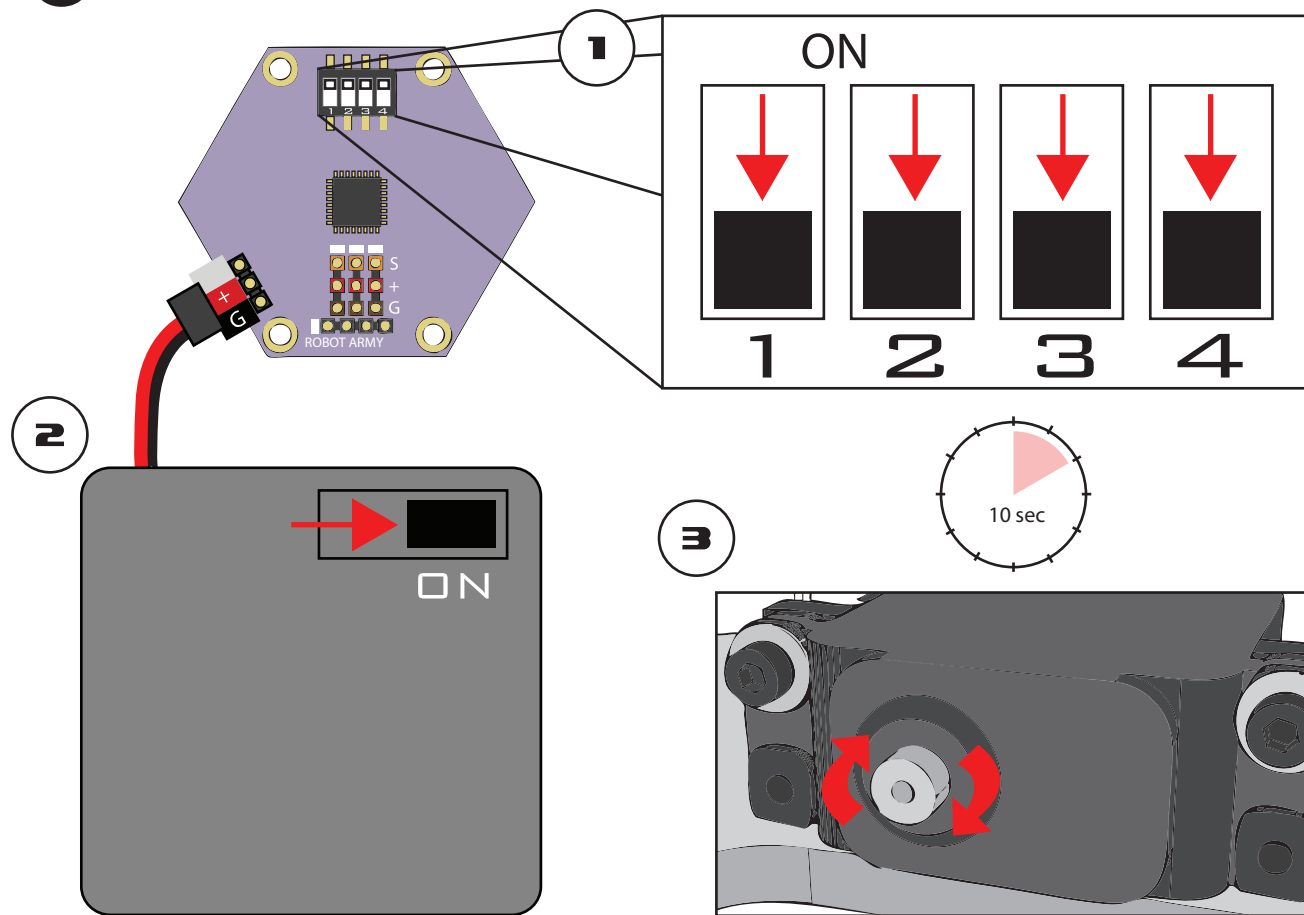



17

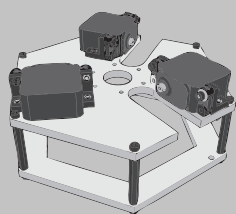

x 1

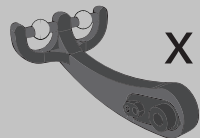

x 3

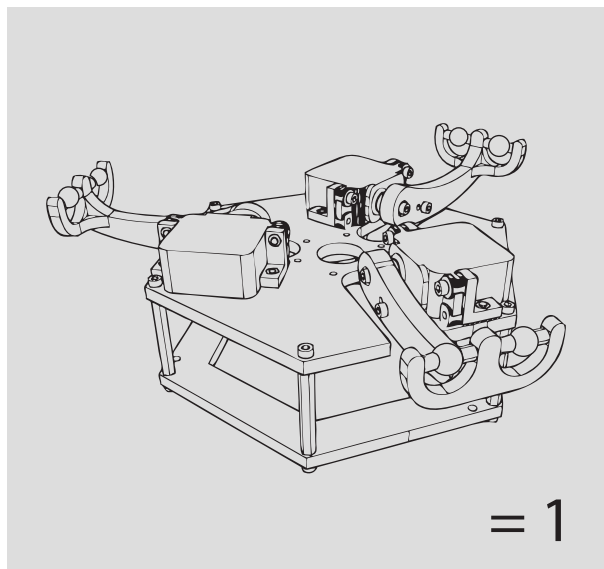
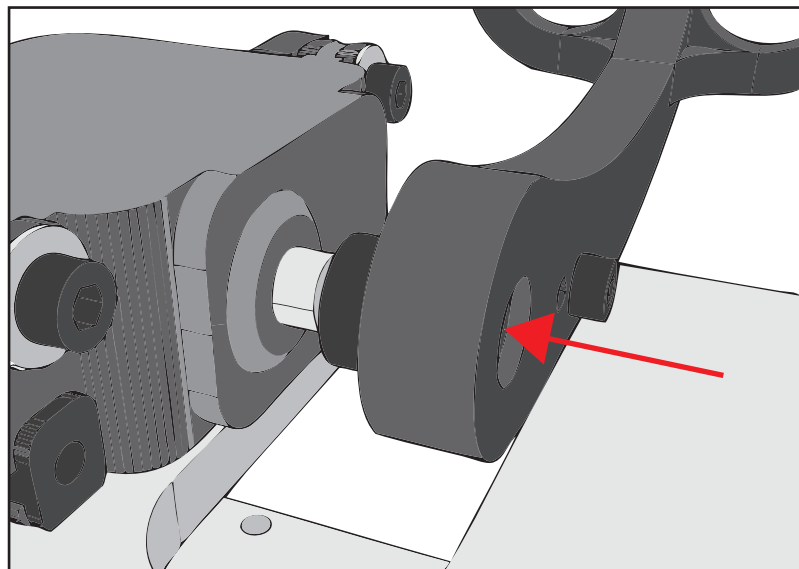
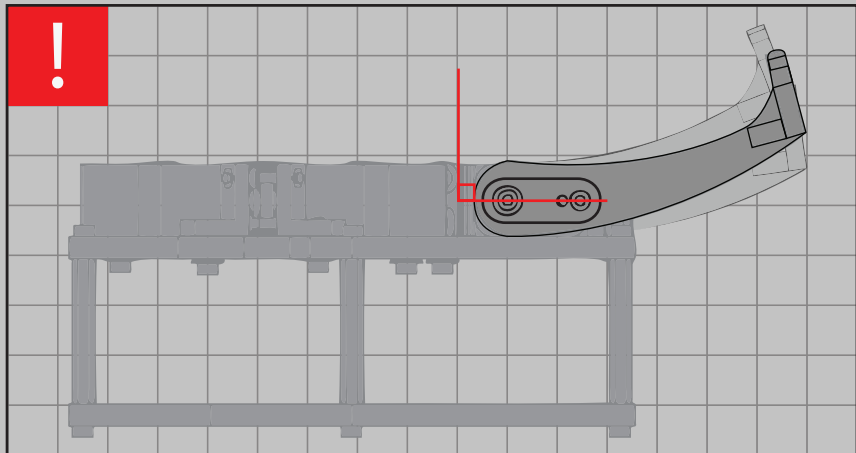

# 18

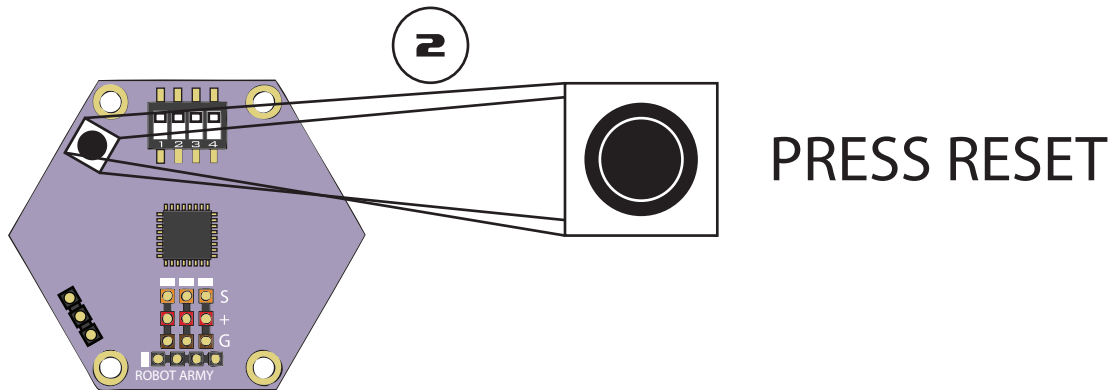
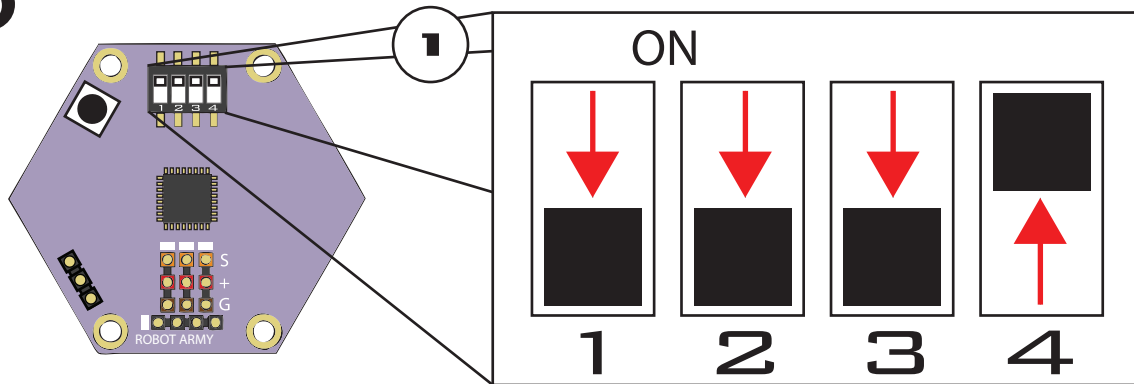



LOWEST  
POINT

HIGHEST  
POINT

# 20

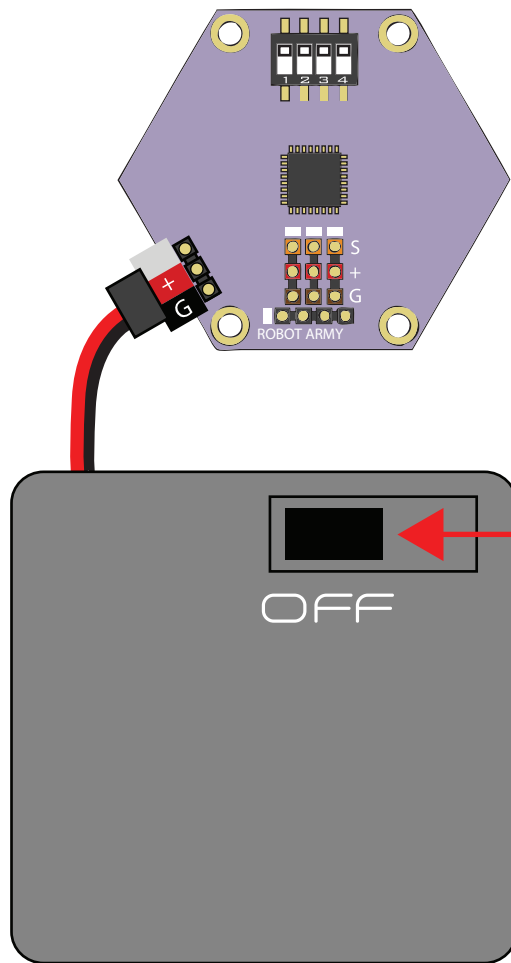

# 21

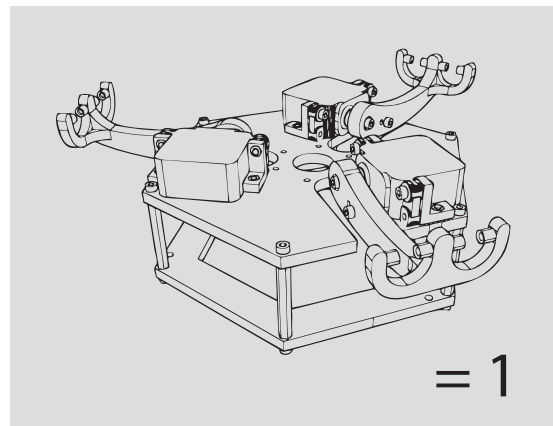
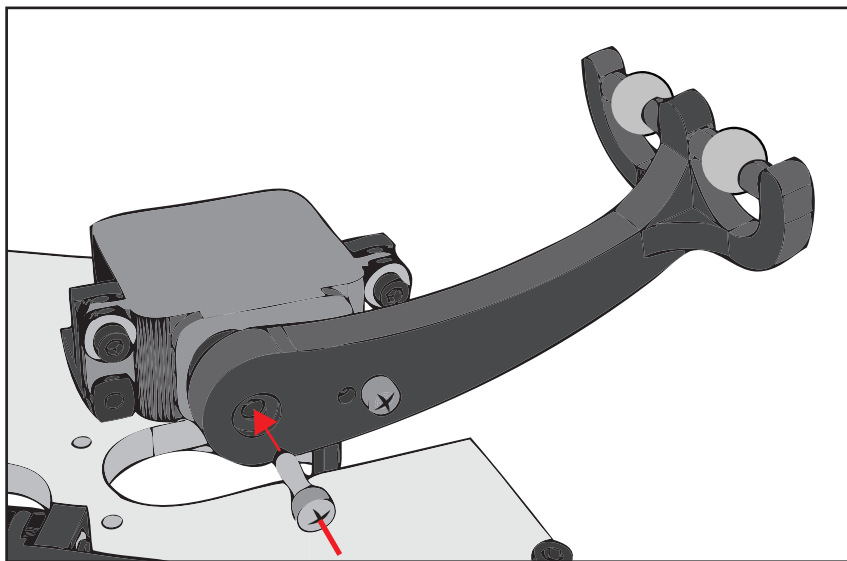
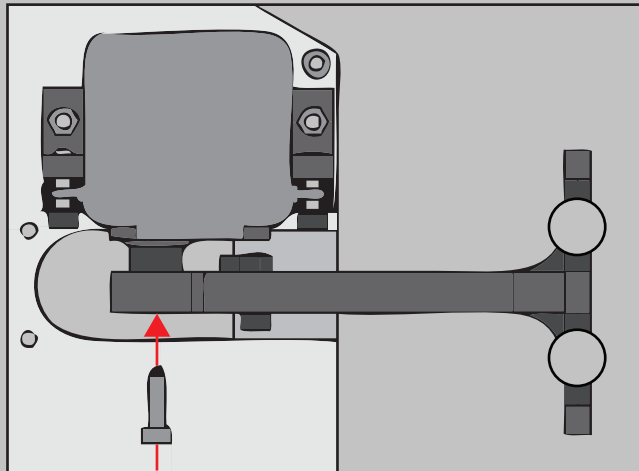
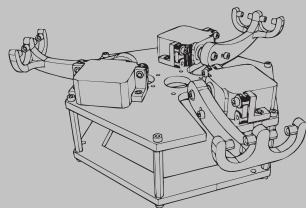

# 22

○ x 6

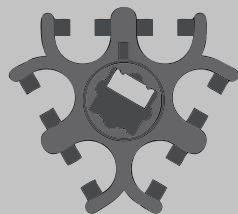

x 1

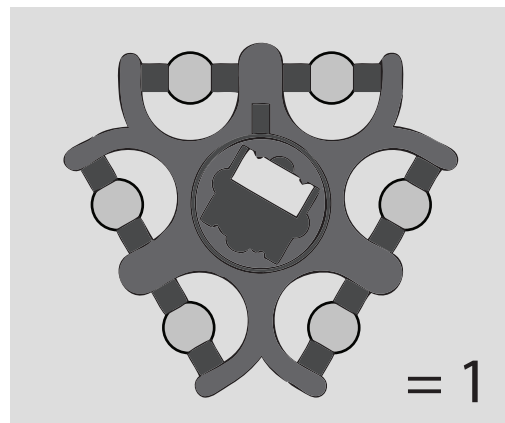
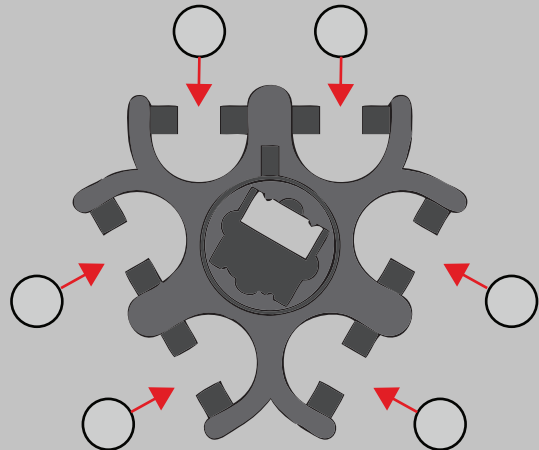
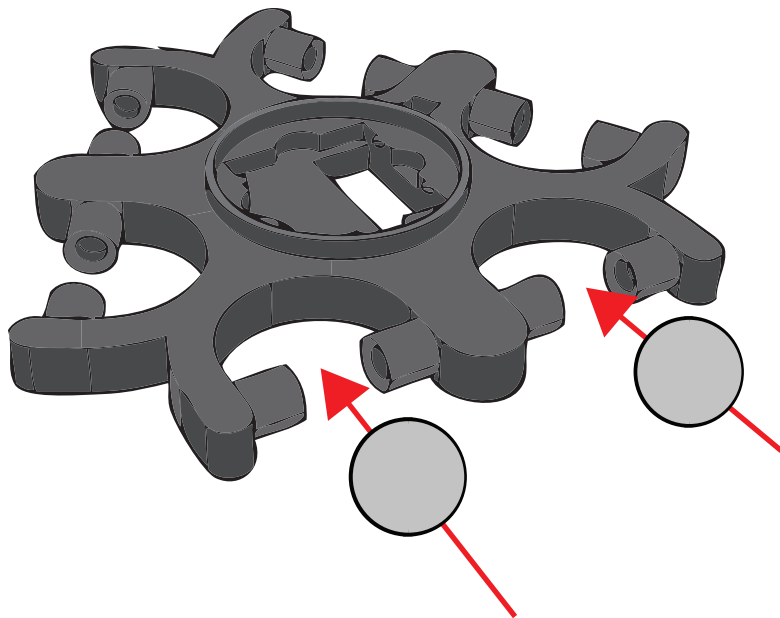

# 23

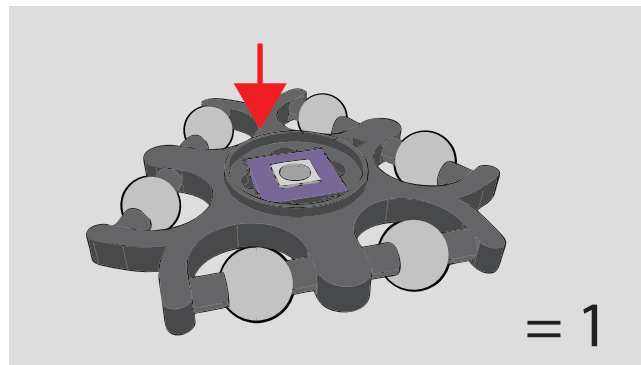
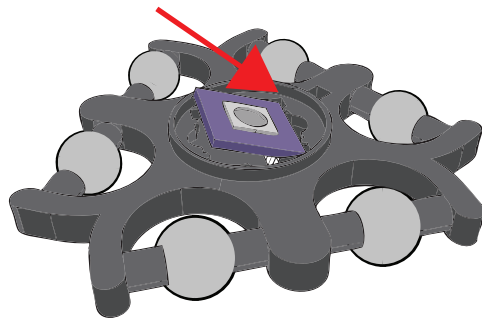
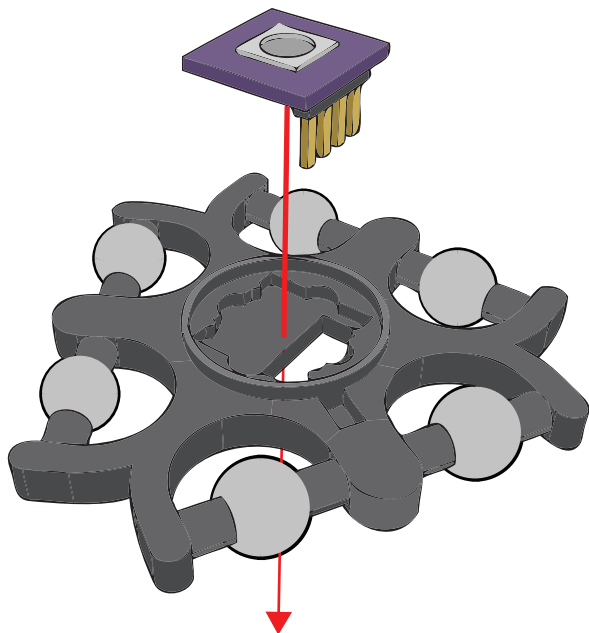
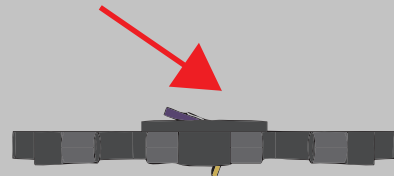
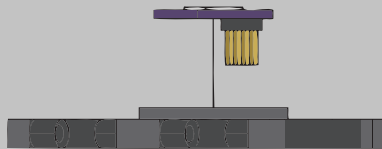
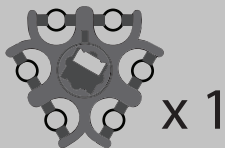
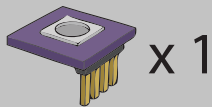

# 24

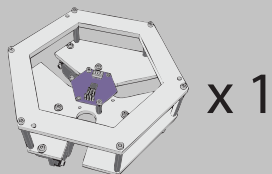

x 1

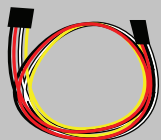

x 1

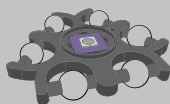

x 1

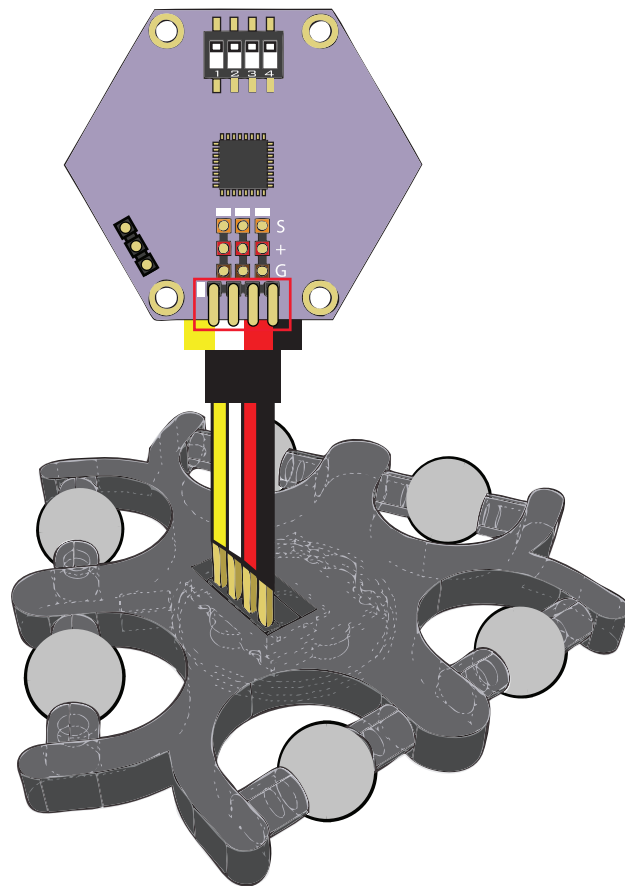
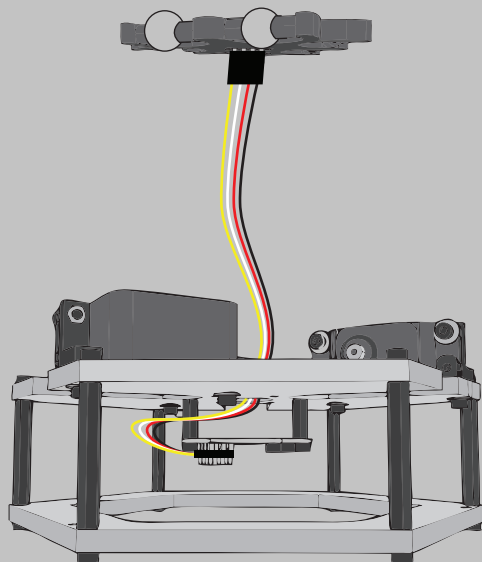



# 25

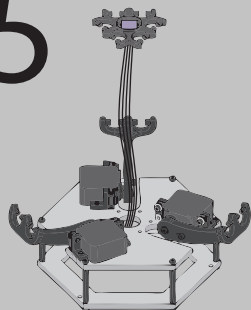

x 1



x 6

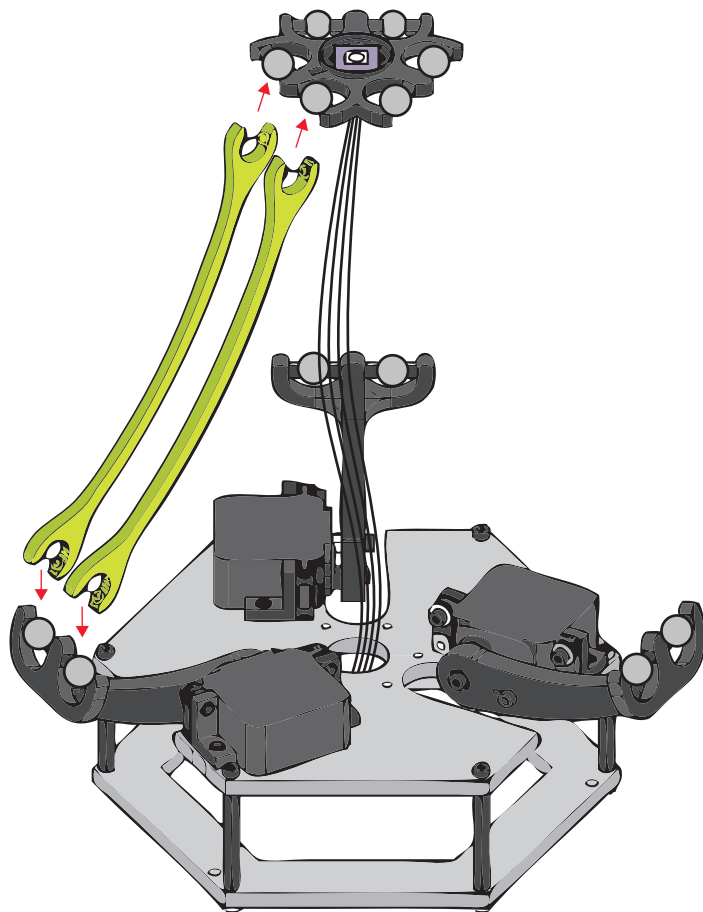

# 26



x 1

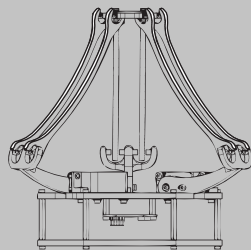

x 1

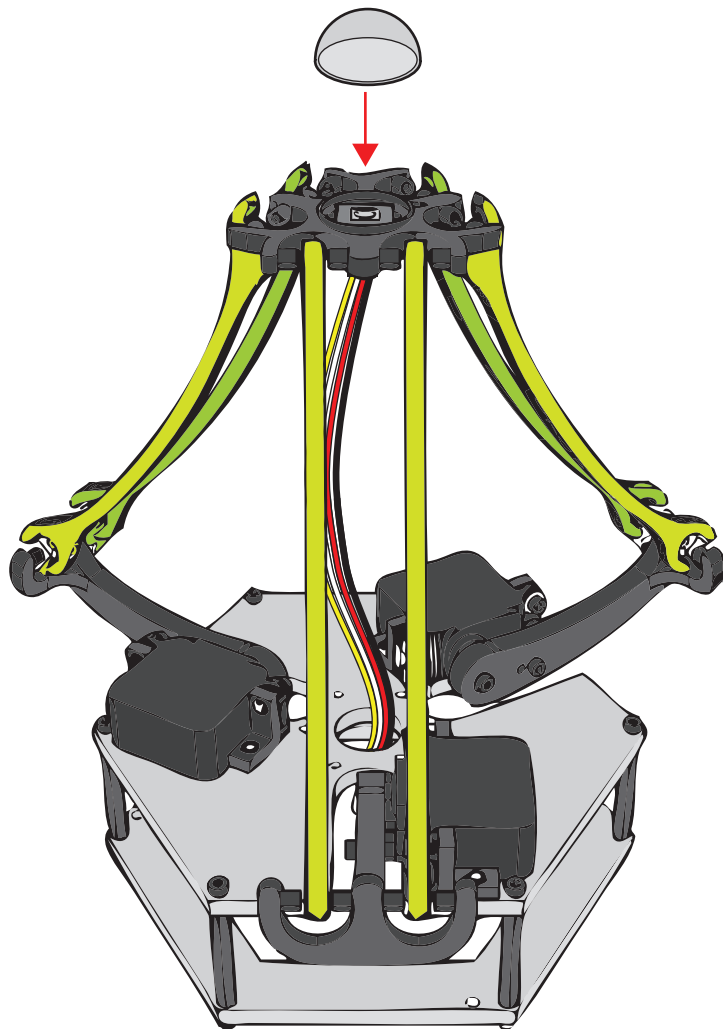
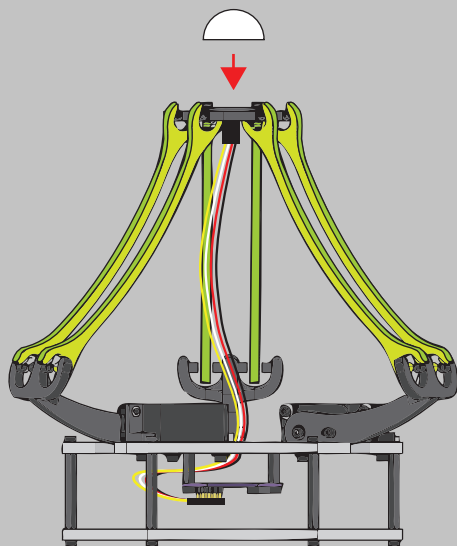

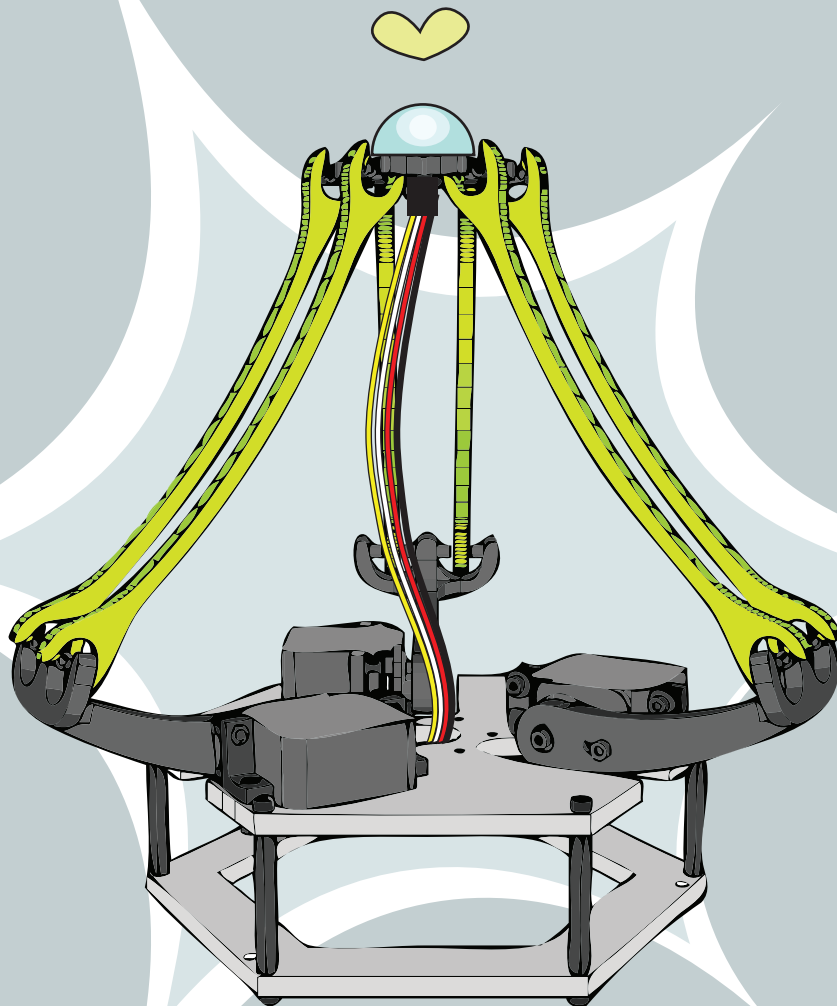



0 : calibrate



1 : up/down

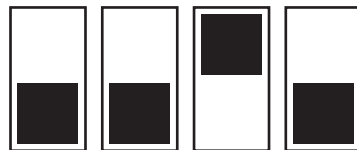

2 : chicken

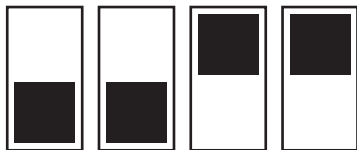

3 : kill

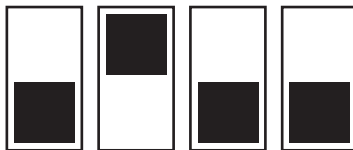

4 : happy

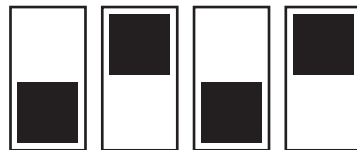

5 : caffeinated



6 : gloomy

## CARE OF YOUR NEWLY ADOPTED DELTA ROBOT!

To ensure that your robot's joints will last over time, avoid detatching and reattaching the ball bearings from the cups.

Do not stick your fingers in the clearance slots when the robot's arms are moving... or else you may get pinched.

If your delta robot's joints become stiff or squeaky over time, you may add a small amount of teflon lubricant to the bearings to loosen them up.